

HIGH ACCURACY PRESSURE TRANSMITTER

±0.05% FS, <±0.25% FS Total Error Band

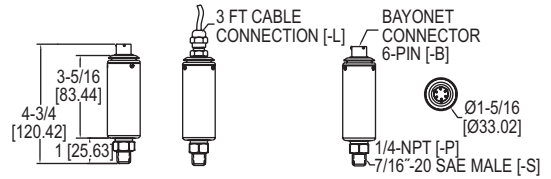

The **Series 644 High Accuracy Pressure Transmitter** is a robust transmitter designed for high accuracy pressure applications. Boasting an accuracy of ±0.05% FS RSS (<±0.25% TEB), the 644 is intended for precise measurements in the critical applications.

FEATURES/BENEFITS

- High accuracy provides exceptional measurement for insuring tight-control and minimizing costly out of specification conditions
- NIST calibrated to provide traceability for regulated processes where production and documentation is monitored
- Low thermal error over a wide range of temperatures helps to insure accurate pressure measurement and process operation

MODEL CHART						
Example	644	-L	-V	-00	-P	644-L-V-00-P
Series	644					Industrial pressure transmitter
Electrical Connection		L B				3 ft cable Male 6-pin bayonet
Signal Output			V C			0 to 10 volt 4 to 20 mA
Range				00 01 02 03 04 05 06 07 08 09 10 11		0 to -14.7 psig 0 to 15 psig 0 to 25 psig 0 to 50 psig 0 to 100 psig 0 to 150 psig 0 to 200 psig 0 to 300 psig 0 to 500 psig 0 to 750 psig 0 to 1000 psig 0 to 15 psia
Process Connection					P S	1/4" male NPT 7/16"-20 SAE male

SPECIFICATIONS

Service: Compatible gases and liquids.
Wetted Materials: 17- 4 PH SS.
Accuracy: ±0.05% FS RSS.
Total Error Band (Includes all thermal effects): <±0.25% FS over entire temperature compensated range.
Stability: < 0.15% FS/year.
Temperature Limits: -40 to 185°F (-40 to 85°C).
Pressure Limits: Proof pressure and burst pressure: See pressure limits table below.
Compensated Temperature Range: -4 to 140°F (-20 to 60°C).
Power Requirements: 9-30 VDC for current output; 15-30 VDC for voltage output.

Minimum Supply Voltage: Min. supply voltage (VDC) for current output = 9 + 0.02 x loop resistance Ω (loop resistance Ω = line resistance + receiver resistance).
Output Signal: 0 to 10 VDC (4-wire); 4 to 20 mA (2-wire).
Response Time: < 10 ms (voltage output), < 80 ms (current output).
Max Current Consumption: 4 to 20 mA: 22 mA; 0 to 10 VDC: 20 mA.
Electrical Connections: 3 ft cable or 6-pin male bayonet connector.
Process Connection: 1/4" male NPT or 7/16"-20 male SAE with O-ring.
Enclosure Rating: NEMA 4X (IP65).
Mounting Orientation: Vertical.
Weight: 9 oz (254 g).
Agency Approvals: CE.

APPLICATIONS

- Calibration equipment
- Hydraulic/pneumatic controls
- Test benches
- Transportation
- Pulp and paper mills
- Power generation

ACCESSORIES

Model	Description
A-495	6-pin female bayonet mate connector

SERIES 638R

OEM PRESSURE TRANSMITTER

Excellent Pressure Surge Resistance, Fast Response

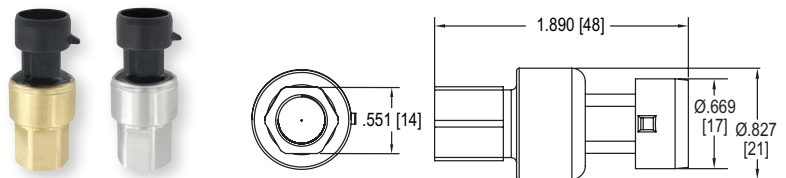

The **Series 638R OEM Pressure Transmitter** is a high-accuracy, low-cost pressure transmitter designed for industrial equipment markets. This transmitter is designed to work with all liquids and gases that are compatible with the wetted materials. The series features a number of configurable options including wetted materials, process connections, and pressure ranges. Whether the application involves aggressive fluids or extreme temperatures, this transmitter is a great option for most applications.

FEATURES/BENEFITS

- High-accuracy pressure transmitter with a fast response time and excellent pressure surge protection
- Suitable for use in applications with extreme temperatures and aggressive fluids
- Highly configurable cost-effective transmitter with a compact design

APPLICATIONS

- HVAC equipment
- Refrigeration equipment
- Refrigerant recovery
- Leak detection systems
- Building pressurization
- Isolated diaphragm packages
- Closed loop hydraulics
- Paint and agriculture spraying

SPECIFICATIONS

Service: Compatible gases and liquids.
Wetted Materials: Brass, aluminum, or 316 SS.
Accuracy: ±1.2% FS (includes linearity, hysteresis, repeatability and calibration); Static error band @ 25°C, 5.0 VDC supply voltage.
Cycle Life: 10 million FS cycles.
Storage Temperature: -40 to 302°F (-40 to 150°C).
Operating Temperature: -40 to 275°F (-40 to 135°C).
Pressure Limit: see model chart.
Thermal Effect: ± 0.013% FS/°C.
Power Supply: 5 VDC.

Output Signal: 0.5-4.5 VDC ratiometric.
Response Time: 10 ms typical.
Output Load: 20 k Ω min. (pull-up or pull-down).
Current Consumption: < 10 mA @ 5.5 VDC (8.5 mA typical).
Electrical Connection: Packard connection.
Process Connection: 7/16" 20 UNF (female) or 1/4" NPT (female).
Enclosure Rating: IP67 (with IP67 plug).
Mounting Orientation: Mount in any position.
Weight: 1.1 oz (30 g).
Agency Approvals: CE.

MODEL CHART							
Example	638R	-00	-P2	-E1	-S2	-SS	638R-00-P2-E1-S1-SS
Series	638R						OEM pressure transmitter
Pressure Range		00 01 02 03 04 05 06					0 to 75 psia (0 to 5.2 bar(a)) 0 to 150 psia (0 to 10.3 bar(a)) 0 to 200 psia (0 to 13.8 bar(a)) 14.5 to 265 psia (1 to 18.3 bar) 14.5 to 315 psia (1 to 21.7 bar(a)) 14.5 to 515 psia (1 to 35.5 bar(a)) 14.5 to 667 psia (1 to 46 bar(a))
Process Connection			P1 P2				7/16" 20 UNF (female) 1/4" NPT (female)
Electrical Connection				E1			Packard connection
Electrical Output					S2		0.5-4.5 V ratiometric
Housing Material						AL BR SS	Aluminum Brass 316L stainless steel